

37126 N100 Macro port 105 for Sony FE 90mm F2.8 Macro G OSS (For NA-A7II)

Instruction Manual

A alignment ring is included in the port for extra stabilization due to the weight and dimension of the lens. This ring should be mounted in the front of lens before installing into the port/housing. Please follow the instruction below for mounting the alignment ring onto the lens.

Alignment ring

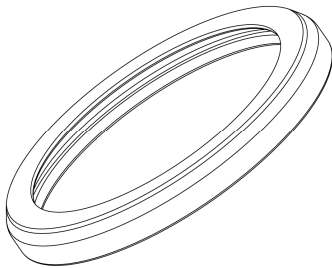

1. Identify of part.

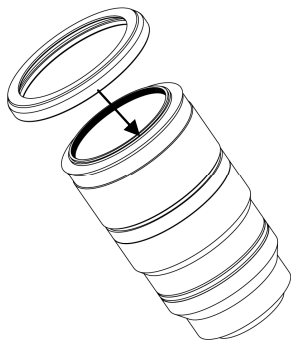

2. Plug the alignment ring on the front of the lens as shown.

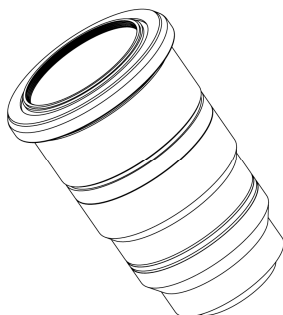

3. Please refer to the housing manual for mounting port onto the housing.